

Strata Star Table Runner

Pattern by Bear Creek Creations
Fabric: European Taupe XI by Kinkame

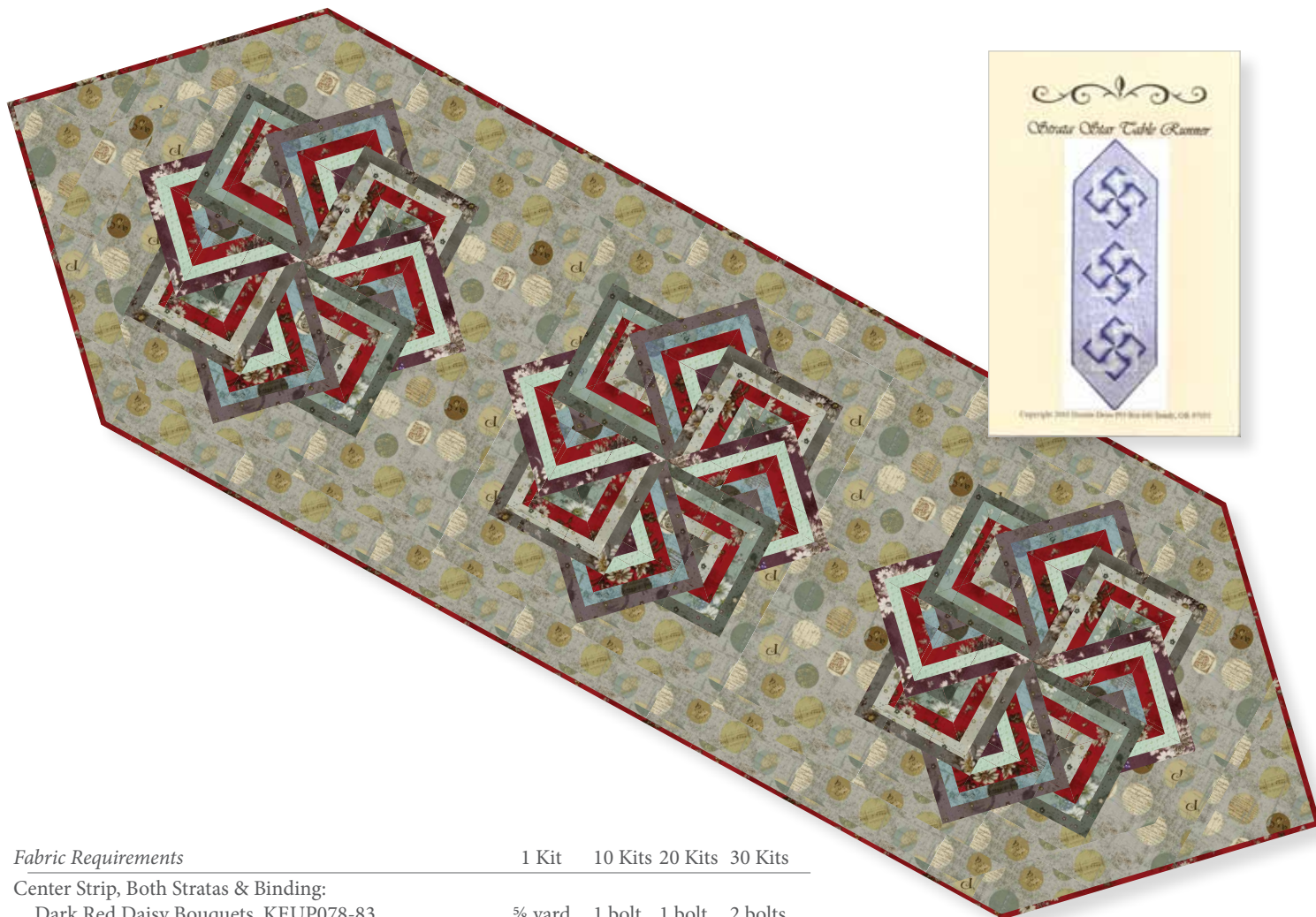

Fabric Requirements

	1 Kit	10 Kits	20 Kits	30 Kits
Center Strip, Both Stratas & Binding:				
Dark Red Daisy Bouquets, KEUP078-83	5/8 yard	1 bolt	1 bolt	2 bolts
Strata #1: Dark Eggplant Daisy Bouquets, KEUP078-46	1/8 yard	1 bolt	1 bolt	1 bolt
Light Mint Herringbone Tonal, KEUP075-109	1/8 yard	1 bolt	1 bolt	1 bolt
Aqua Large Dots, KEUP079-33	1/8 yard	1 bolt	1 bolt	1 bolt
Dark Eggplant Rings and Flowers, KEUP076-46	1/8 yard	1 bolt	1 bolt	1 bolt
Strata #2: Dark Gray Daisy Bouquets, KEUP078-7	1/8 yard	1 bolt	1 bolt	1 bolt
Light Khaki Rings and Flowers, KEUP076-11	1/8 yard	1 bolt	1 bolt	1 bolt
Dark Mint Daisy Bouquets, KEUP078-111	1/8 yard	1 bolt	1 bolt	1 bolt
Forest Flower Sprigs, KEUP077-113	1/8 yard	1 bolt	1 bolt	1 bolt
Background: Gray Large Dots, KEUP079-6	3/4 yard	1 bolt	1 bolt	2 bolts
Suggested Backing: Dark Brick Flower Sprigs, KEUP077-52	1 yard	1 bolt	2 bolts	2 bolts

Assembly note: To piece as shown, cut 3 WOF strips of each Strata fabric (6 strips of Red). Assemble as directed using the darkest strips at the outside. When cut into triangles, keep the two sets separate and alternate piecing them into the star shape.

Bear Creek Creations/Paradise Quilts
Order "Strata Star Table Runner"

www.paradisequilts.net
paradisequilts@frontier.com

(503) 668-3106

Designed by Dennis Dries